

A close-up photograph of a person's hand pointing at architectural blueprints spread on a table. Another hand is visible holding a black marker. In the background, a laptop and a person wearing a blue denim shirt are partially visible. The scene is lit with warm, golden light, suggesting an indoor setting with large windows.

Building & Property Committee Meeting

2020 03 02



E-Rate Fiber Project

High School to Oak
Flat Elementary
Route 2 (C)

High School

High school to back of property along
X country course
Treeline to north side of CVRT to
Centerville Rd

Oak Flat



Administration Building to
Newville Elementary Route 1

Newville

DO to Mount Rock
Schoolhouse and Carlisle Rd to Mill Rd
Over BS Creek to Shepherd
N High to Green into Newville Elementary

DAO



E-RATE FIBER PROJECT

- eRate Bid Filing generated three responses
 - Velocity Fiber (National)
 - Celerity Integrated Services (Quakertown, PA)
 - Snyder Electric (Harrisburg, PA) – Did not comply with bid process
- Companies that received invitations to bid
 - DQE Communications, Pittsburgh PA
 - Comcast, Philadelphia PA
 - Cogent Communications, Washington DC
 - Consolidated Communications, Pittsburgh, PA
 - PenTeleData, Palmerton, PA
 - Verizon, New York, NY
 - Lighttower Fiber Networks, Boxborough, MA
 - Windstream Communications, Little Rock, AR
 - Crown Castle Fiber, Houston, TX
 - One Tel, North Salt Lake, UT
 - Xtel Communications, Mt Laurel Township, NJ



E-RATE FIBER SERVICE BID SUMMARY

VELOCITY FIBER NETWORKS LEASED DARK FIBER

VELOCITY FIBER NETWORKS LEASED DARK FIBER 12 STRAND - MONTHLY COST 66 MONTH TERM			ANNUAL POLE FEES	TOTAL DISTRICT ESTIMATED COSTS FIRST YEAR	ANNUAL POLE FEES	TOTAL DISTRICT ESTIMATED COSTS ANNUALLY AFTER FIRST YEAR
	ONE-TIME INSTALL	MONTHLY COST	ESTIMATED POLE FEES			10GB
VELOCITY	\$340,460	\$4,372	\$0	\$392,924	\$0	\$52,464
Erate Discount	\$238,322	\$3,060	\$0	\$275,047	\$0	\$36,725
District Fair-share	\$102,138	\$1,312	\$0	\$117,877	\$0	\$15,739



E-RATE WAN/FIBER SERVICE BID SUMMARY

CELERITY INTEGRATED SERVICES OWNED DARK FIBER

CELERITY INTEGRATED SERVICES FIRST YEAR OWNED DARK FIBER 12 STRAND ONE-TIME COST			ANNUAL POLE FEES	TOTAL DISTRICT ESTIMATED COSTS FIRST YEAR	ANNUAL POLE FEES	TOTAL DISTRICT ESTIMATED COSTS ANNUALLY AFTER FIRST YEAR
	ONE-TIME INSTALL	ESTIMATED ROCK NTE	ESTIMATED POLE FEES		ESTIMATED POLE FEES	
CELERITY	\$251,180	\$37,025	\$1,650	\$289,855	\$1,650	
Erate Discount	\$175,826	\$25,918	\$1,155	\$202,899	\$1,155	
District Fair-share	\$75,354	\$11,108	\$495	\$86,957	\$495	\$495



E-RATE FIBER SERVICE Next Steps

- Board Approval to award bid to Celerity Integrated Services
- District to file E-Rate 471 Application process requesting form to begin the process of requesting the discounts
 - May take 6 to 12 months for EPC response
- Finalize PP&L Pole attachment agreement
 - PP&L has 60 days (starts when agreement is submitted) to complete their pole attachment engineering study to finalize pole make ready costs and then 90 days to complete the makeready
 - Engineering Estimate \$12,800
 - Make-Ready Estimate \$19,250
- Prepare and submit CV Rail Trail easement
- Prepare and submit all necessary PennDot and/or municipal permit applications
 - Estimate \$750



(revised)
Summer **2020**
Construction Projects



revised

Summer 2020 Construction Projects

<u>Bldg</u>	<u>Project</u>	<u>Vendor</u>	<u>Cost</u>	<u>Notes</u>
MS/HS	<u>Interactive Panel Purchase</u>	Visual Sound	\$830,000.00	COSTARS
MS/HS	<u>Interactive Panel Install</u>	KPN/Lobar	\$205,000.00	KPN
MS/HS	<u>Classroom furniture Retrofit</u>	CRA/tbd	\$450,000.00	COSTARS
DAO	<u>Condition Basement</u>	KPN/Lobar	\$121,990.00	KPN
DAO	<u>Air Balance Bldg</u>	KPN/Lobar	\$5,610.00	KPN
DAO	<u>Planetarium Seal & Insulate</u>	KPN/Lobar	\$12,056.86	KPN
HS	<u>Retrofit LED to Commons</u>	Schaedler	\$48,261.00	COSTARS
MS	Warehouse Reno	local	\$16,000.00	local
		Total =	\$1,688,917.86	

Interactive Panel Project Costs



The Source for Audio Visual Solutions![®]
A Certified Woman Owned Business Enterprise

Proposal:

Prices listed are per unit. Shipping is included. Includes 3 Yr. Warranty

SMART 86" Interactive Display with IQ and SMART Learning Suite
Model # SBID-7286R **with** built-in Windows 10 \$7263.32
Wall Mount Included
Pricing INCLUDES Shipping!

SMART 86" Interactive Display with IQ and SMART Learning Suite
Model # SBID-7286R **without** built-in Windows 10 \$5968.32
Wall Mount Included
Pricing INCLUDES Shipping!

Interactive Panel & Associated Costs



Manufacturer

Smart 7086 Per Panel	\$5,968
Middle School Panels	49
High School Panels	66
Total	115

Est Panel Purchase	\$686,357
Desktops, Display, cables	\$98,000
Mobile Carts	\$12,500
Soundbars	\$28,750
Total Equipment Purchase	\$825,607

KPN Installation at \$1761 per unit \$202,515

Total \$1,028,122

Re: IQC Master Contract #: KPN-201801JOCC-16
 JOC Work Order #: 073993.00
 Owner PO #:
 Title: Big Spring School District Install TV-Whiteboards
 Contractor: Lobar Associates Construction
 Proposal Value: \$1,761.02

KPN Proposal: Panel Installation

Sect.	Item	Mod.	UOM	Description	Line Total
Labor	Equip.	Material	(Excludes)		
Base Bid					
1	01 22 20 00 0016		HR	LaborerFor tasks not included in the Construction Task Catalog® and as directed by owner only.	\$168.79
				Installation	
			Quantity	Unit Price	Factor = Total
			2.00 x	64.67 x	1.3050 = 168.79
				Staging and trash removal	
2	01 22 20 00 0016		HR	LaborerFor tasks not included in the Construction Task Catalog® and as directed by owner only.	\$253.18
				Installation	
			Quantity	Unit Price	Factor = Total
			3.00 x	64.67 x	1.3050 = 253.18
				prep room, replace ceiling tile, clean up	
3	50 00 00 00 0017			Lump Sur AV Solutions SMART TV Installation	\$1,339.05
				Installation	
			Quantity	Unit Price	Factor = Total
			1.00 x	1,339.05 x	1.0000 = 1,339.05
				SMART TV Installation Over the board mount, HDMI Cable and USB Cable installation	
Subtotal for Base Bid					\$1,761.02
Proposal Total					\$1,761.02

cost per panel

DAO Basement Fix

Re: IQC Master Contract #: KPN-201801JOCC-19
 JOC Work Order #: 073379.00
 Owner PO #:
 Title: Big Spring School District Add Condition Spaces to District Office
 Contractor: Lobar Associates Construction
 Proposal Value: \$127,600.00

Sect.	Item	Mod.	UOM	Description	Line Total
Labor Equip. Material (Excludes)					
Basement AC					
1	23 00 00 00 0004		unit	VAV Boxes, Supply/Return Air, Controls, Transfer Ducts	\$121,990.00
		NPP		Installation Quantity Unit Price Factor = Total 1.10 x 110,900.00 x 1.0000 = 121,990.00 Install HVAC in basement as per plans. No ceiling tile, patching, painting, permit, bond, eng, cutting patching of walls or demo of existing	
				10,724 SF	
Subtotal for Basement AC					\$121,990.00
Optional 1st floor					
2	23 00 00 00 0004		Unit	Balance First Floor & AHU	\$5,610.00
		NPP		Installation Quantity Unit Price Factor = Total 1.10 x 5,100.00 x 1.0000 = 5,610.00 Optional. balance first floor & ahu	
Subtotal for Optional 1st floor					\$5,610.00
Proposal Total					\$127,600.00



DAO Fix Planetarium

Re: IQC Master Contract #: KPN-201801JOCC-19
JOC Work Order #: 073379.02
Owner PO #:
Title: Big Spring School District Admin Office Planetarium Insulation Upper Floor Ceiling
Contractor: Lobar Associates Construction
Proposal Value: \$12,056.86

Ceiling	\$5,912.92
General Conditions	\$1,870.05
Insulation	\$1,112.65
Spray Foam	\$3,161.24
Proposal Total	\$12,056.86

RE: Proposal to install insulation above DAO suspended ceiling



Rick,

It is our recommendation to not install insulation on the existing acoustical ceiling for the following reasons (reference the attached diagram):

- 1. The ceiling plenum and the room are at similar temperature. This is because the air in the room is being cycled through the plenum, making it conditioned space. Additionally, the plenum space is gaining some heat from conduction through the ACT panels which keeps the return air warmer as it makes its way back to the air handler (minimal).
- 2. If insulation is installed on the existing ACT ceiling, it will reduce the conduction of heat to the plenum space through the ACT. This reduction can reduce the temperature of the plenum space due to losses through the roof which will cause the air handler to work harder (less-efficient).
- 3. Maintenance will be messier and more difficult as the insulation will make moving the ceiling panels more difficult and reduce the plenum space
- 4. It will be harder to trace wires and components that travel through the plenum space.
- 5. The added weight to the ACT will cause the panels to sag over time. (rockwool is heavy, 10lbs per ACT panel)
- 6. The acoustical ceiling grid was not design to handle all of the extra weight that adding insulation will add.

In lieu of these points, the efficiency can be increased by adding further insulation to the roof (currently has R16) or installing spray foam insulation to the underside of the deck. This will reduce the losses to the outside through the roof and make the air handler work less (more-efficient). Additional action points for increasing the building efficiency would be to install a more efficient air handler, install insulated return ducting, further insulate walls and install higher efficiency windows/doors.

Best Regards,
Jeremiah Pease-Myers
Project Engineer/ Project Administrator



Insulation Diagram

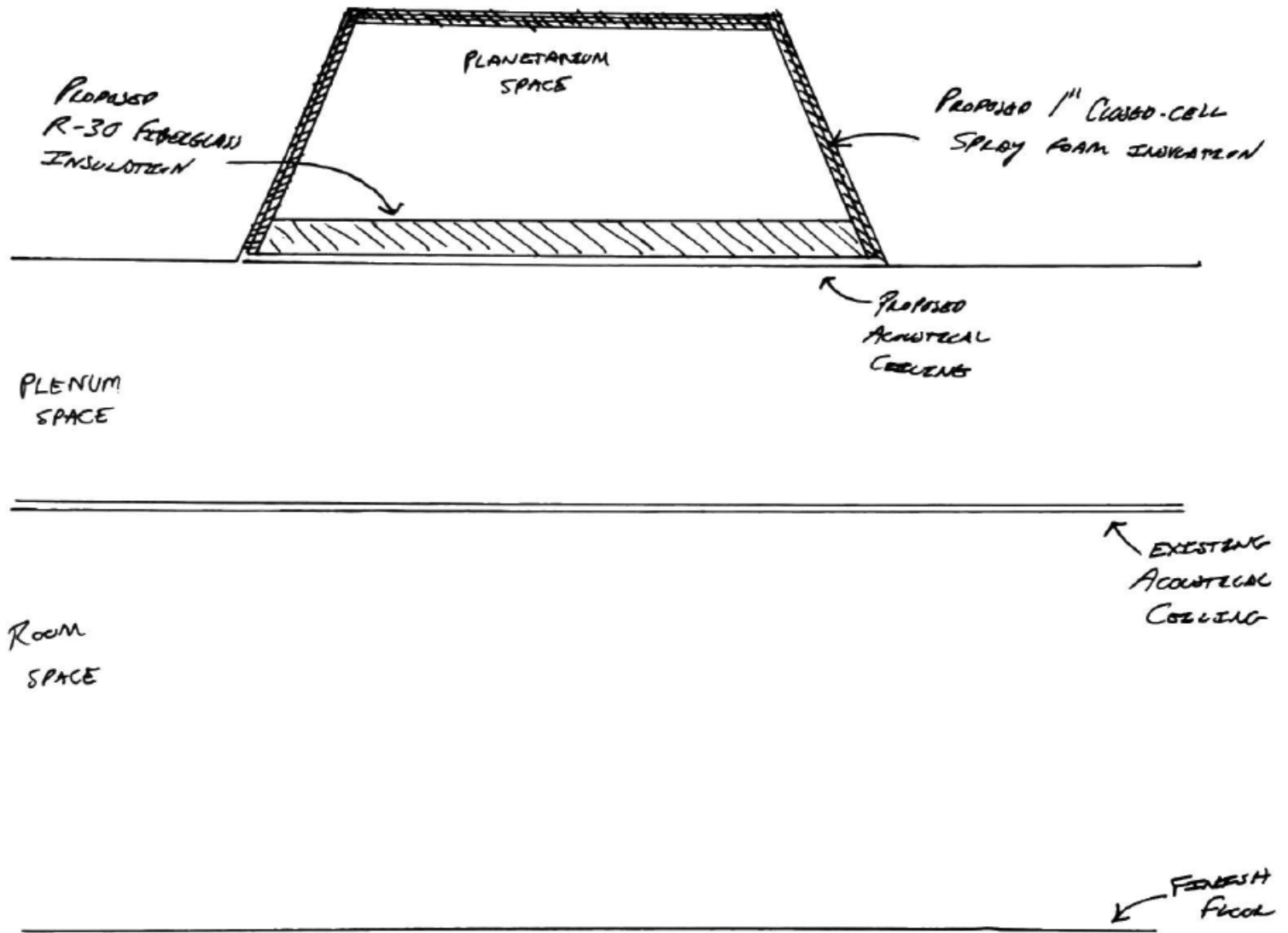



HS Commons LED Lighting

CUSTOMER NUMBER	JOB NAME		REQUESTED BY	
79951	Big Spring HS Common - COSTAR		Tim Drawbaugh	
WRITER	SHIP VIA	TERMS	SHIP DATE	IS FREIGHT ALLOWED?
SHANNON MCNE	1UPS	Standard 10th Prox		No
ORDER QTY	DESCRIPTION		UNIT PRICE	NET AMOUNT
12EA	COOPER 845-27-PSJWAC-L10/840-UNV-MW-48		1689.066EA	20268.79
6EA	SYL RT8/10/TRIMEXT/75083 75083 RT8 TRIM EXTENDER FOR 10 INCH CAN APPLICATIONS		6.555EA	39.33
6EA	SYL LEDRT8/R3A2000UD/940/60781 8" WHITE RECESSED DOWNLIGHT ULTRA LED RETROFIT KIT, 23W, 2000LM, 120/277V, 0-10V DIMMABLE, 4000K, 90 CRI, CFL FRAME RETROFIT AND STAND ALONE FIXTURE, NO HOUSING REQUIRED >>>PPL REBATE OF \$8 IS APPLIED<<<		53.025EA	318.15
64EA	SYL PANELF1A/040UNVD840/24G/WH 74250 EDGE LIT FLAT PANEL LED 40W DIMMABLE 80+CRI 4000K 4200LM 2X4 FOR LAY IN GRID CEILINGS WHITE PAINTED 40W ***PPL REBATE OF \$10 IS APPLIED ***		58.000EA	3712.00
1EA	LABOR FOR CO-STARS PROJECTS ONLY		22923.000EA	22923.00

\$ 47,261.27

Crabtree, Rohrbaugh & Associates Architects



BIG SPRING SCHOOL DISTRICT – CONCEPT FURNITURE PRESENTATION



BIG SPRING HIGH SCHOOL

(New)
 Big Spring High School
 100 Mt. Rock Road
 Newville, Pennsylvania

West Pennsboro Twp.

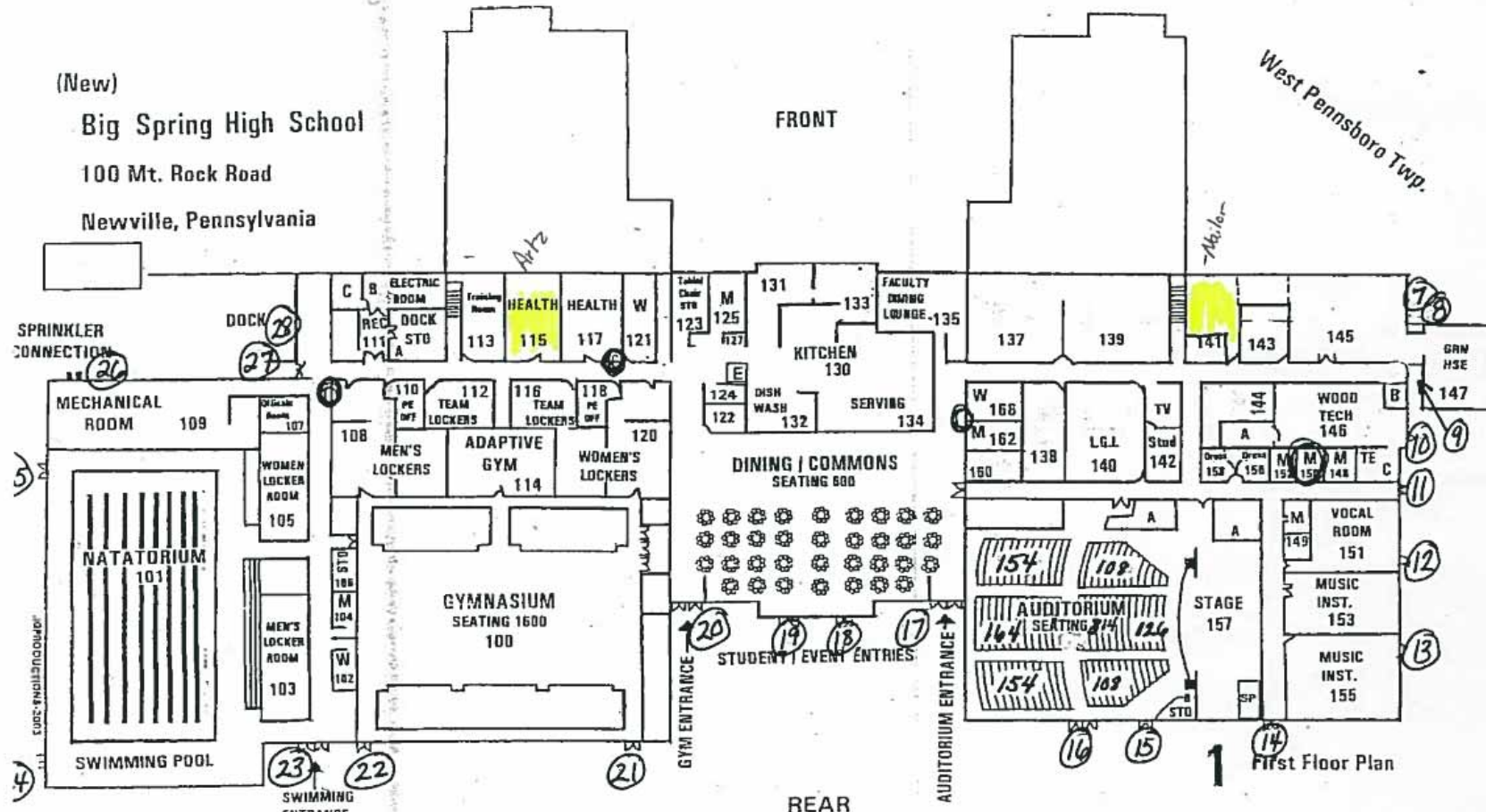

1 First Floor Plan

FIRST FLOOR PLAN

E = Elevator

BUS LOADING / UNLOADING

○
 FIRE
 HYDRANT

BIG SPRING HIGH SCHOOL

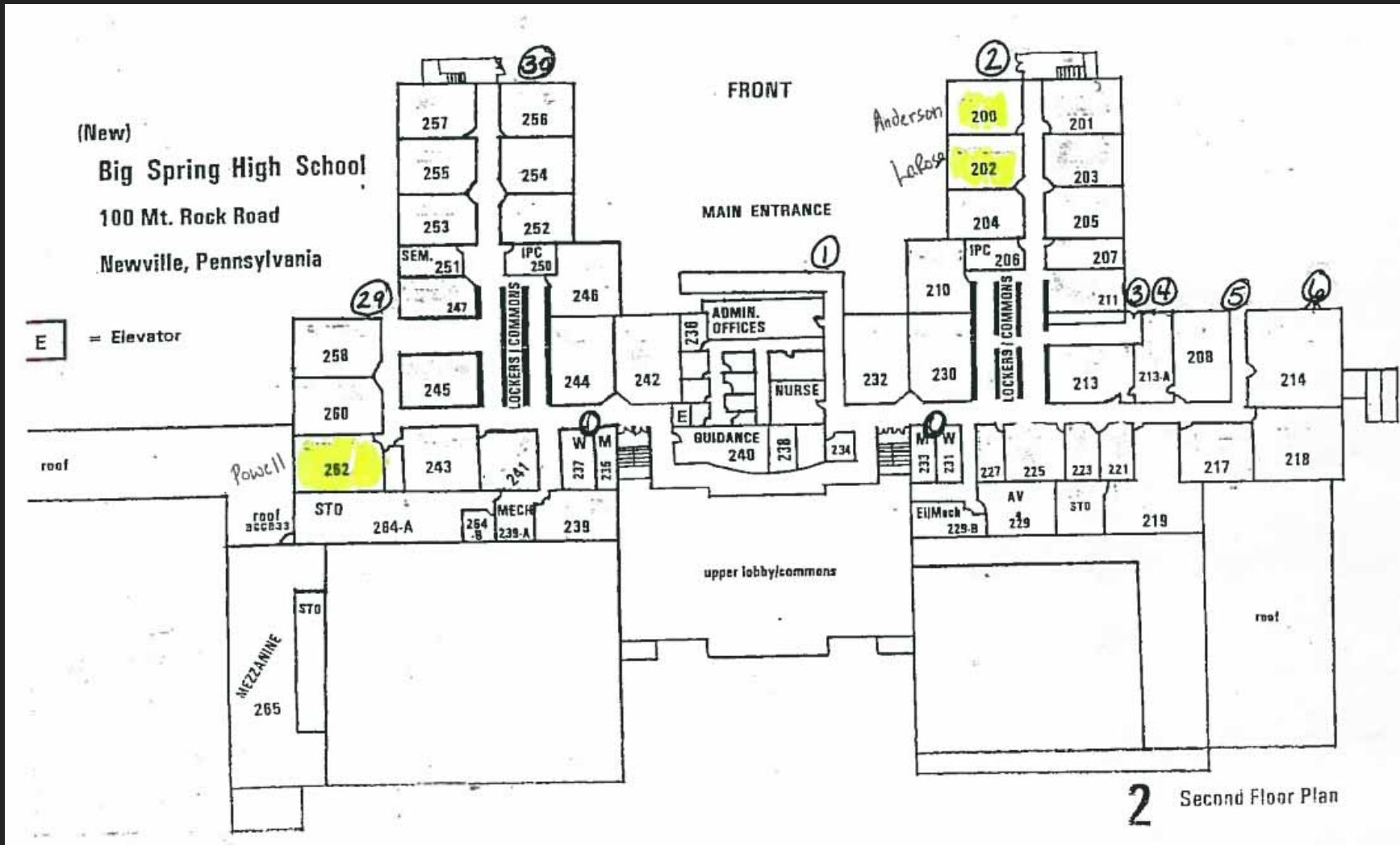

SECOND FLOOR PLAN

BIG SPRING HIGH SCHOOL

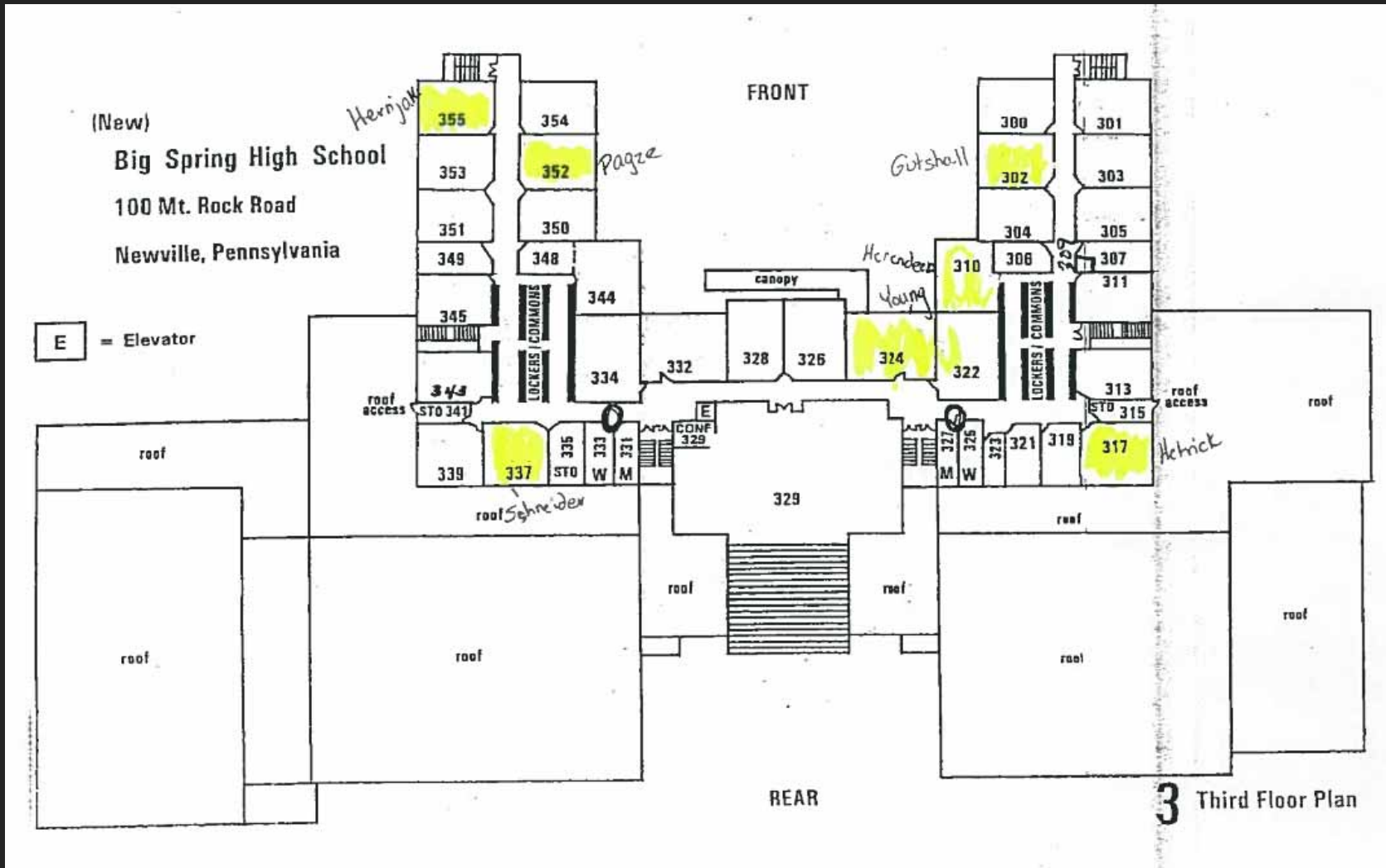

THIRD FLOOR PLAN

BIG SPRING MIDDLE SCHOOL

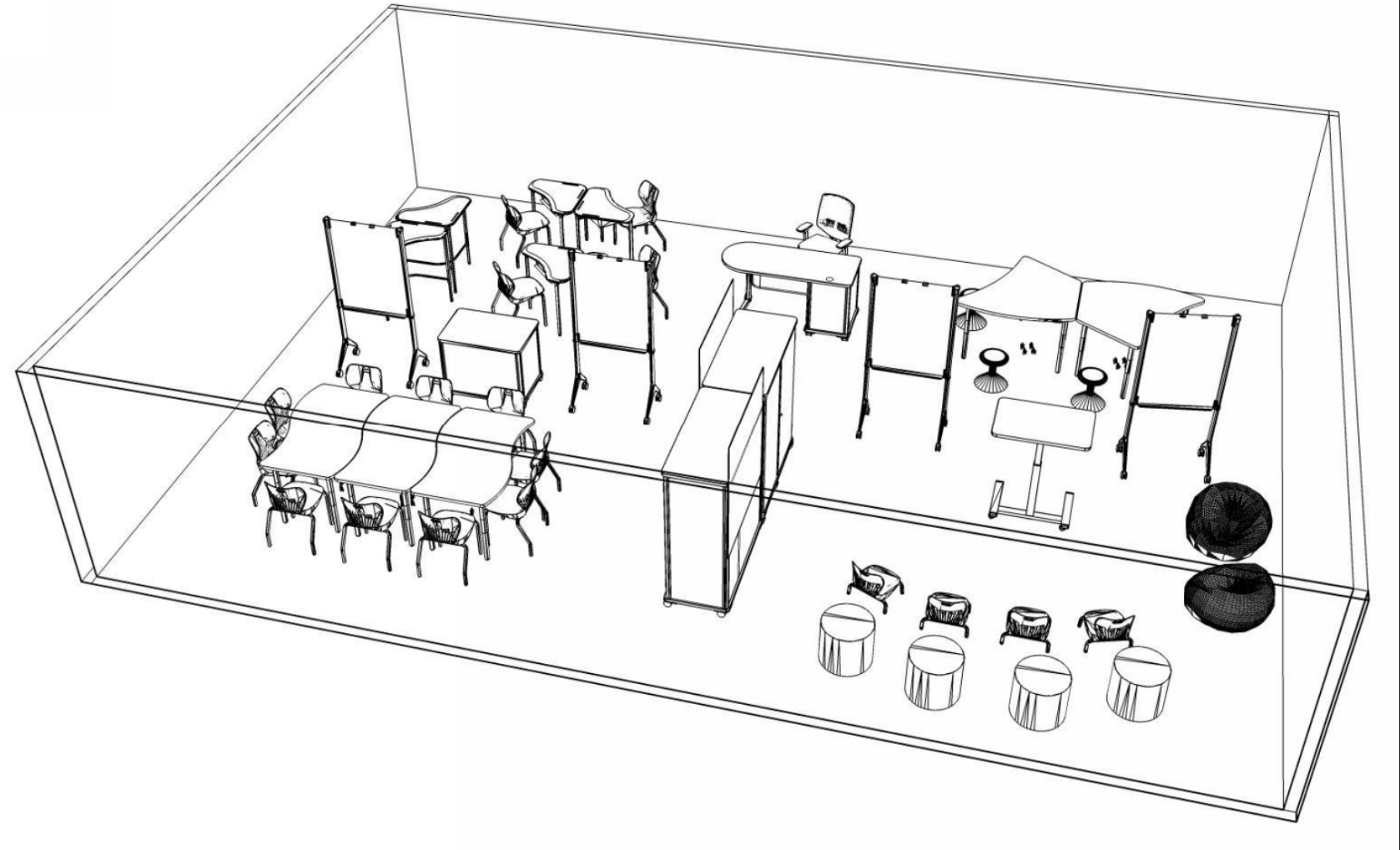

CLASSROOM OPTIONS

BIG SPRING MIDDLE SCHOOL



CLASSROOM FURNITURE OPTIONS

BIG SPRING MIDDLE SCHOOL



CLASSROOM FURNITURE OPTIONS

BIG SPRING MIDDLE SCHOOL



CLASSROOM FURNITURE OPTIONS

BIG SPRING HIGH SCHOOL

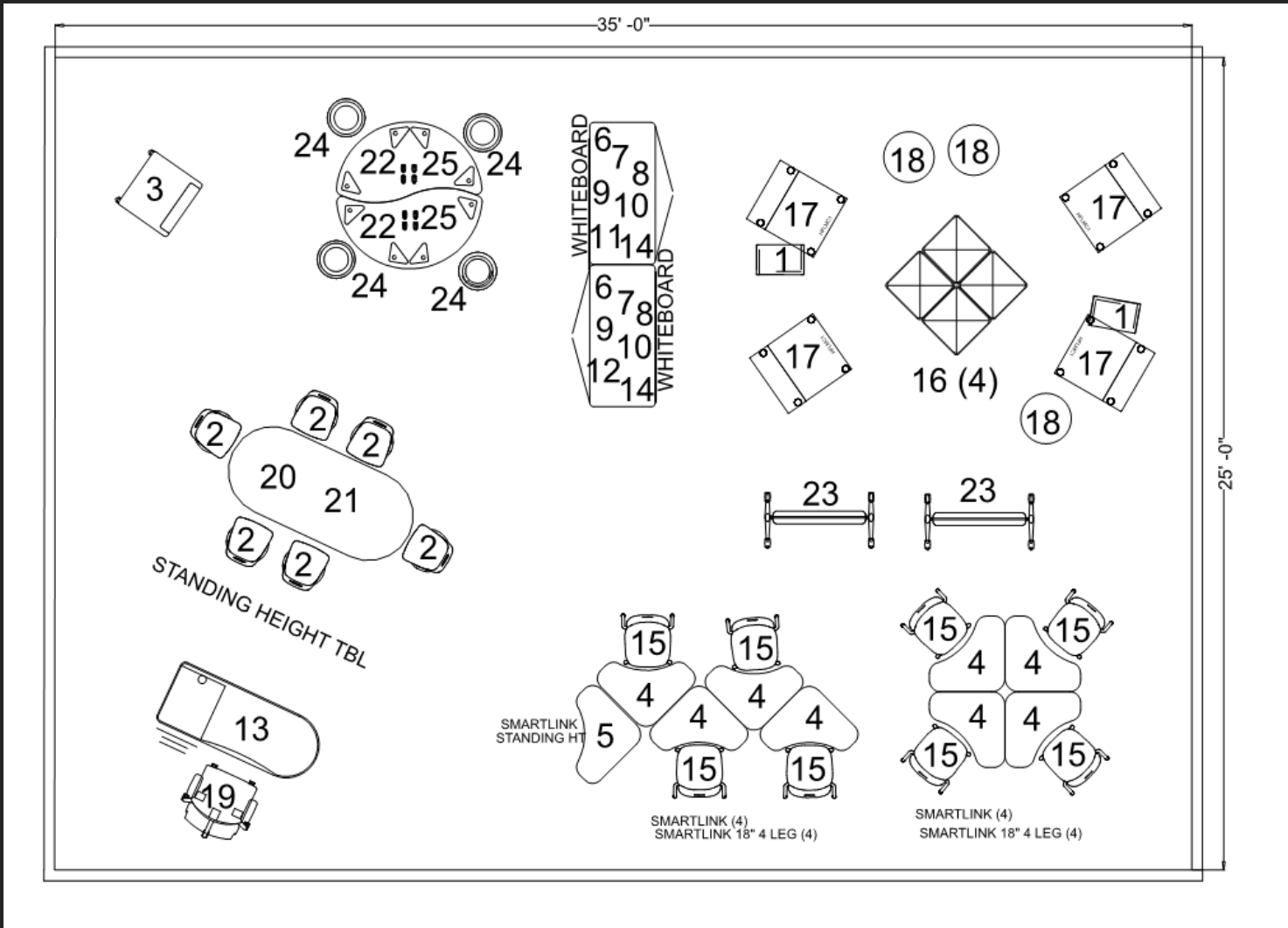

CLASSROOM OPTIONS

BIG SPRING HIGH SCHOOL

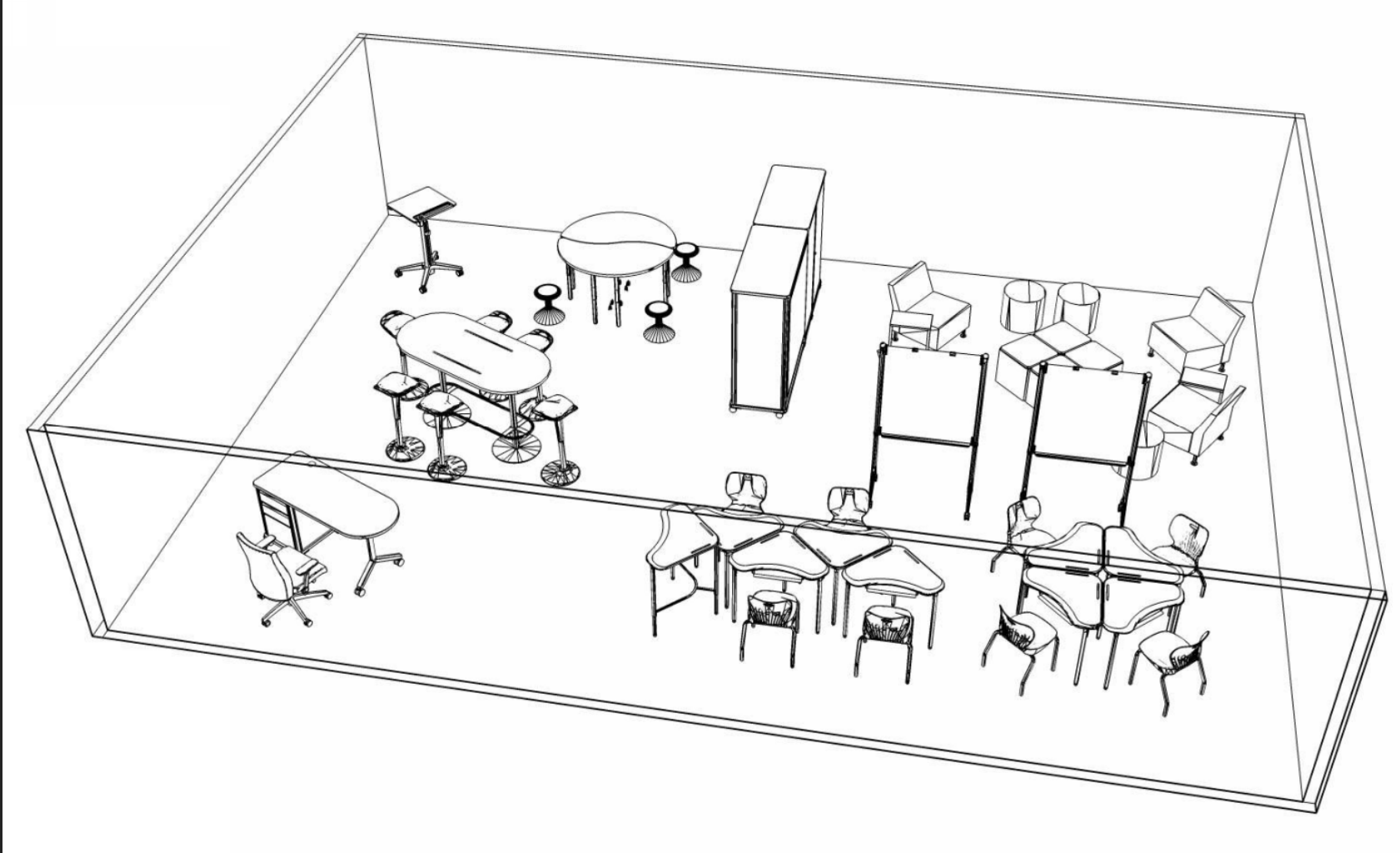

CLASSROOM OPTIONS



BIG SPRING HIGH SCHOOL



CLASSROOM FURNITURE OPTIONS

FURNITURE PROCESS & COST ESTIMATES

- PROCESS – MET WITH STAKEHOLDERS TO GATHER INFORMATION/REQUIREMENTS
- BUDGET – UTILIZED INFORMATION FROM MEETINGS TO CREATE THE BUDGETS FOR EACH SCHOOL
- NEXT STEPS – REQUEST COMPETITIVE QUOTES FROM 3-4 VENDORS USING FURNITURE ESTABLISHED AS ‘BASIS OF DESIGN’
- STATE CONTRACT QUOTES ALLOWS THE DISTRICT TO SELECT THE COST OPTION THAT WORKS WITH YOUR BUDGET
- OVERALL BUDGET RANGE \$350,000 - \$412,500

 Crabtree, Rohrbaugh & Associates Architects 401 East Winding Hill Road Mechanicsburg, Pennsylvania 17055 phone: (717) 458-0272 - fax: (717) 458-0047		
Big Spring School District CRA Project No.: 3392		
Master Furniture Cost Information		
Big Spring Middle School		
Furniture (includes 5,000/7 rooms, 10,000/11 rooms, 10,000/11 rooms)	\$255,000.00	
Installation	\$25,500.00	
Total		\$280,500.00
Big Spring High School		
Furniture (includes 10,000/12 rooms)	\$120,000.00	
Installation	\$12,000.00	
Total		\$132,000.00
Completed August 2020 Total		\$ 412,500.00

11 committed

11 Investigating first



Questions