

1 LARGE GROUP INSTRUCTION  
14.6 1/4" = 1'-0"

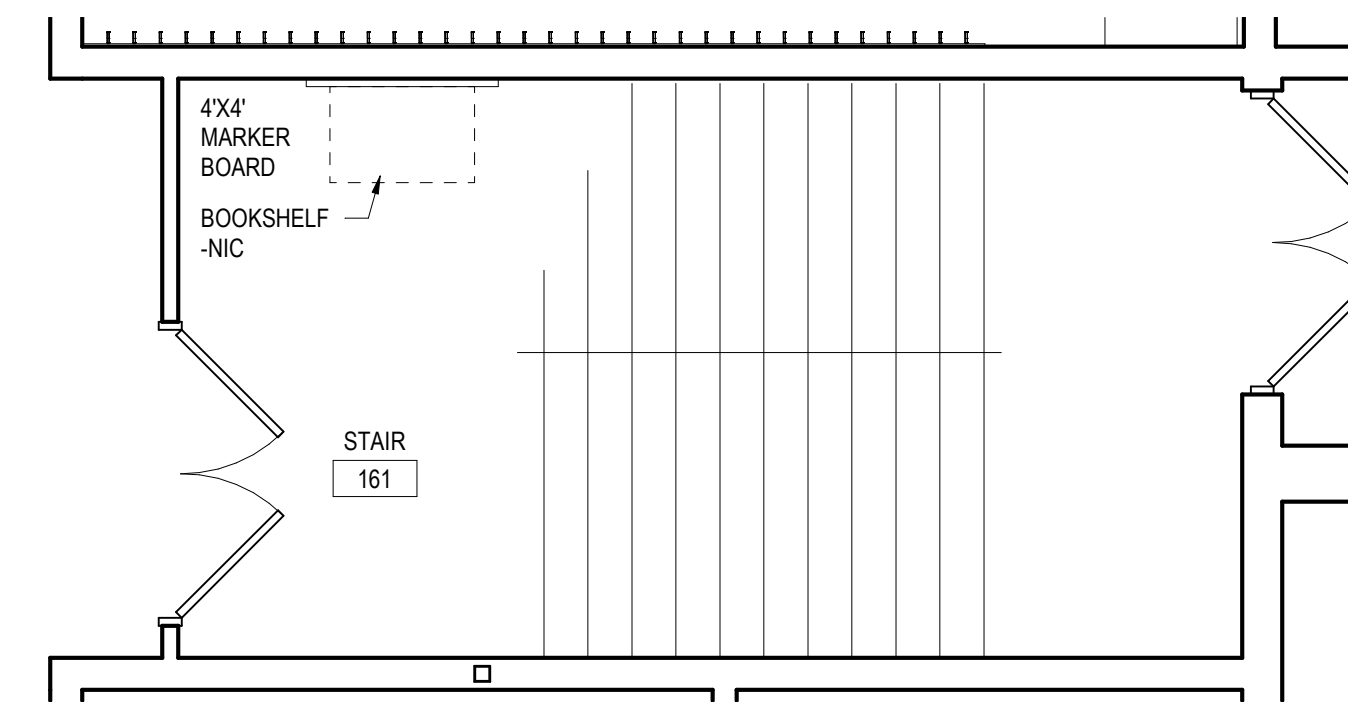

3 STAIR TYP  
14.6 1/4" = 1'-0"

\*LAYOUT SHALL BE APPLIED TO THE FOLLOWING ROOMS: 161, 183, & 185.

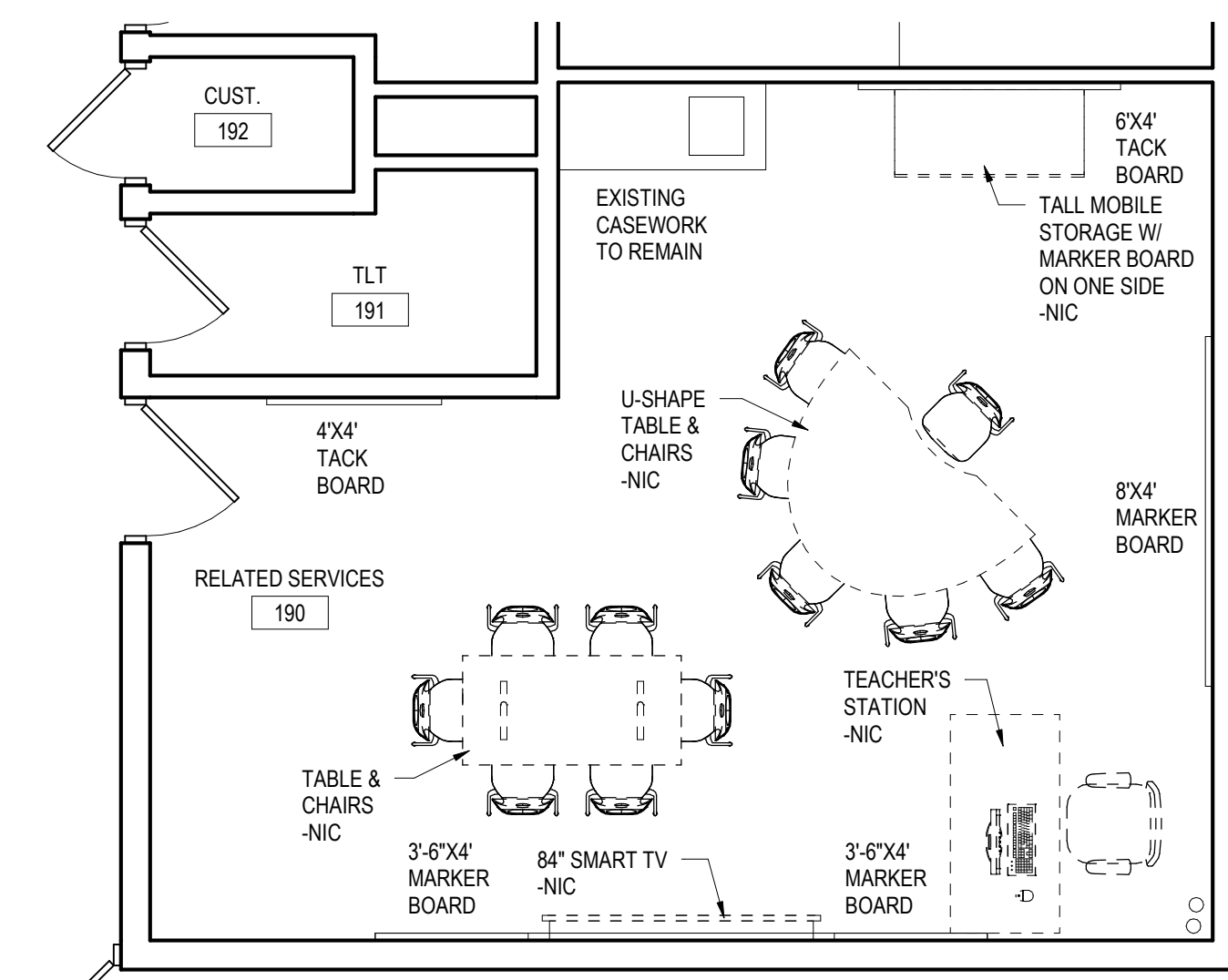

4 RELATED SERVICES  
14.6 1/4" = 1'-0"

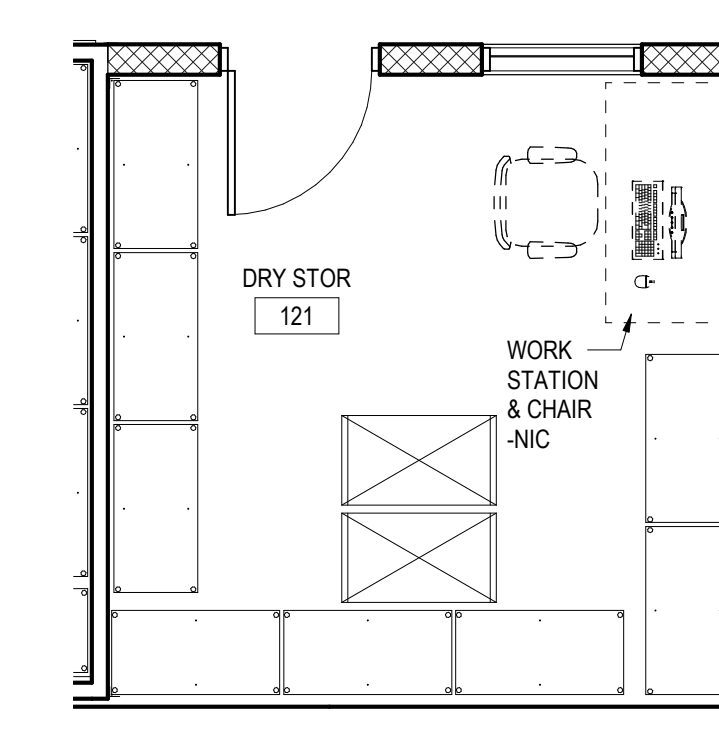

5 KITCHEN OFFICE  
14.6 1/4" = 1'-0"

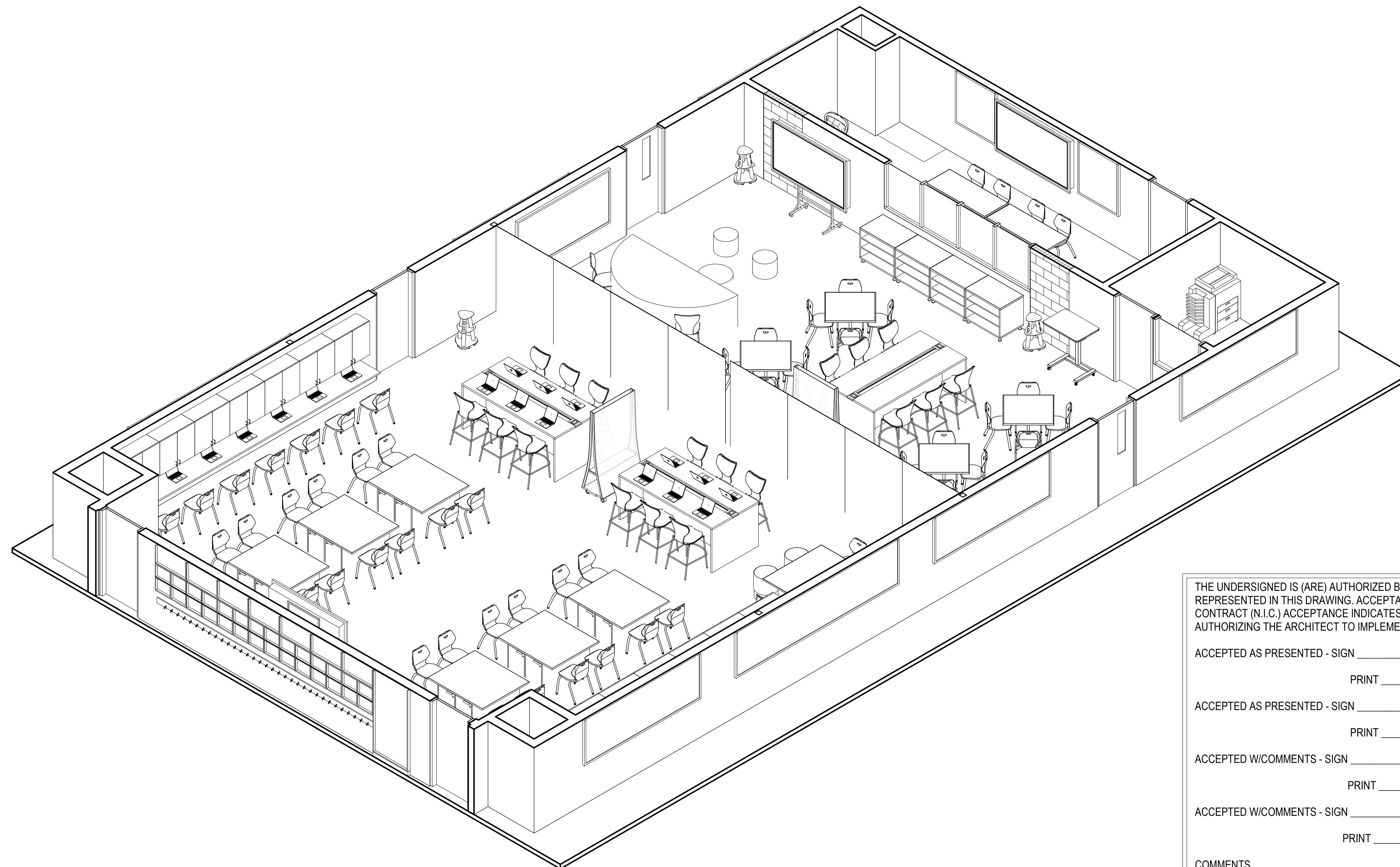

2 LGI - 3D VIEW  
14.6

THE UNDERSIGNED IS (ARE) AUTHORIZED BY THE SCHOOL DISTRICT TO REVIEW AND ACCEPT THE DESIGN OF THE BUILDING SPACE(S) REPRESENTED IN THIS DRAWING. ACCEPTANCE INCLUDES SIZE, SHAPE, ROOM LAYOUT, AND CONTENTS, INCLUDING ITEMS NOT IN CONTRACT (N.I.C.). ACCEPTANCE INDICATES THAT THE UNDERSIGNED HAS REVIEWED THE INFORMATION WITH THE ARCHITECT AND IS AUTHORIZING THE ARCHITECT TO IMPLEMENT THE DESIGN IN THE FINAL CONSTRUCTION DOCUMENTS.

ACCEPTED AS PRESENTED - SIGN \_\_\_\_\_ DATE \_\_\_\_\_  
PRINT \_\_\_\_\_  
ACCEPTED AS PRESENTED - SIGN \_\_\_\_\_ DATE \_\_\_\_\_  
PRINT \_\_\_\_\_  
ACCEPTED W/COMMENTS - SIGN \_\_\_\_\_ DATE \_\_\_\_\_  
PRINT \_\_\_\_\_  
ACCEPTED W/COMMENTS - SIGN \_\_\_\_\_ DATE \_\_\_\_\_  
PRINT \_\_\_\_\_

COMMENTS

1. \_\_\_\_\_  
2. \_\_\_\_\_  
3. \_\_\_\_\_

GENERAL NOTE IN REFERENCE TO I4.6

1. ALL CASEWORK IN LGI SHALL RECEIVE LOCKS.
2. ALL SINKS SHALL RECEIVE BUBBLERS.

GRADE 1-5 MOUNTING HEIGHT SCHEDULE

MARKER BOARD	2'-6" AFF TO BOTTOM EDGE
TACK BOARD	2'-6" AFF TO BOTTOM EDGE
BASE CABINETS	2'-6" AFF TO TOP OF CABINET
WALL CABINETS	7'-0" AFF TO TOP OF CABINET
SMART TV - OWNER PROVIDED/OWNER INSTALLED	2'-6" AFF TO BOTTOM EDGE



LARGE SCALE LAYOUT LGI & MISCELLANEOUS

PLOT SCALE: 1/4" = 1'-0"  
FILENAME:  
DATE: 09/21/18

**CRABTREE ROHRBAUGH & ASSOCIATES - ARCHITECTS**  
401 EAST WINDING HILL ROAD  
MECHANICSBURG PA 17055  
717-458-0272

BALTIMORE, MARYLAND  
CHARLOTTESVILLE, VIRGINIA  
WHITE SULPHUR SPRINGS, WEST VIRGINIA

www.cra-architects.com

RENOVATIONS TO  
**BIG SPRING MOUNT ROCK ELEMENTARY**  
BIG SPRING SCHOOL DISTRICT  
43 MOUNT ROCK ROAD, NEWVILLE PA 17241

**PROJECT**  
3196.1  
**14.6**

REVISIONS

NO.	DATE	BY	DESCRIPTION OF CHANGES

ALL REPORTS, PLANS, SPECIFICATIONS AND COMPUTER FILES RELATING TO THIS PROJECT ARE THE PROPERTY OF CRABTREE ROHRBAUGH & ASSOCIATES. CRABTREE ROHRBAUGH & ASSOCIATES RETAINS ALL COMMON LAW, STATUTE AND OTHER RESERVED RIGHTS INCLUDING THE COPYRIGHT THEREIN. REPRODUCTION OF THE MATERIAL HEREIN OR SUBSTANTIAL USE WITHOUT WRITTEN PERMISSION OF CRABTREE ROHRBAUGH & ASSOCIATES VIOLATES THE COPYRIGHT LAWS OF THE UNITED STATES AND WILL BE SUBJECT TO LEGAL PROSECUTION.  
© CRABTREE ROHRBAUGH & ASSOCIATES, INC. 2018